



Similar to illustration

## Toploader Ecotop 50

⊕	Volume	<b>50 litres</b>
⊙	Int. dimensions (w x d x h)	<b>Ø400 x 380 mm</b>
⏻	Power	<b>3.6 kW</b>
Ⓒ	Tanw *	<b>1260°C</b>

\* **Application temperature** for long-term and continuous use.

## Technical data

### ☰ Overview

Product group	<b>Kiln</b>
Design	<b>Toploader</b>
Type	<b>Ecotop series</b>

### ⏻ Energy

Energy type	<b>Electrical</b>
Power	<b>3.6 kW</b>
Supply	<b>16 A</b>
Voltage	<b>230V</b>
Connection	<b>Schuko connector</b>

### ⊕ Dimensions

Volume	<b>50 litres</b>
Int. dimensions (w x d x h)	<b>Ø400 x 380 mm</b>
Ext. dimensions (W x D x H)	<b>700 x 730 x 830 mm</b>
Weight	<b>58 kg</b>

### ☆ Equipment

Insulation	<b>3-layer, microporous</b>
Heating	<b>All-around</b>
Heating elements	<b>Recessed into bricks</b>
Control	<b>TC 304</b>

## Besondere Merkmale

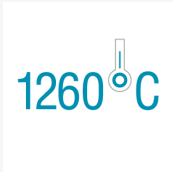

### Long-term application temperature Tapp 1260°C

The kiln is designed for long-term and continuous use at temperatures up to 1260°C which makes it suitable for applications such as bisque, earthenware, onglaze and stoneware firing as well as high-temperature stoneware, soft paste porcelain firings. These applications correspond to Seger Cone 7 or Orton Cone 7.



### Power supply with 230 V "Schuko" plug connector

The high-quality insulation allows the kiln to be fired safely at stoneware temperatures using a regular 230 V "Schuko" plug connector (3.6 kW).



### Gas pressure spring-supported opening mechanism for the lid

The sturdy lid construction is supported by gas pressure springs that allow easy, effortless and safe opening of the lid.



### Reversible kiln stand, handy and practical

The kiln stand can be turned upside-down. This allows the kiln to be used at two different working heights. The toploader can be adjusted to your individual needs and makes loading and unloading of the firing chamber much easier on the back.



### Integrated safety due to safety switch

A door contact switch automatically isolates the heating elements from the power supply when the kiln opens. The integrated overtemperature protection prevents damage to electrical components.

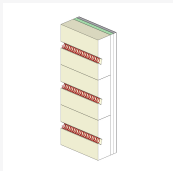

### Particularly high energy efficiency

The kiln is currently one of the most economical kilns on the market thanks to a unique, 3-layer insulation concept with an additional 15 mm microporous insulating board.



## High-quality heating elements

With the heating elements made from "Kanthal A1" we attach great importance to a low surface load and a careful production. The heating elements are reliable and durable thanks to a sufficient reserve capacity in the calculation.



## Disassembly

The kiln can be disassembled easily into several parts for on-site delivery. The toploader's design allows its individual parts to fit through doors with a width of 55 cm.



## 3-year warranty

We produce each kiln by hand and keep to strict quality guidelines. Therefore, we offer a voluntary 36-months warranty to extend legal warranty regulations.